

Sands-Constellation Center for Critical Care

Medical ICU and Medical/Surgical Unit

FLOOR 5

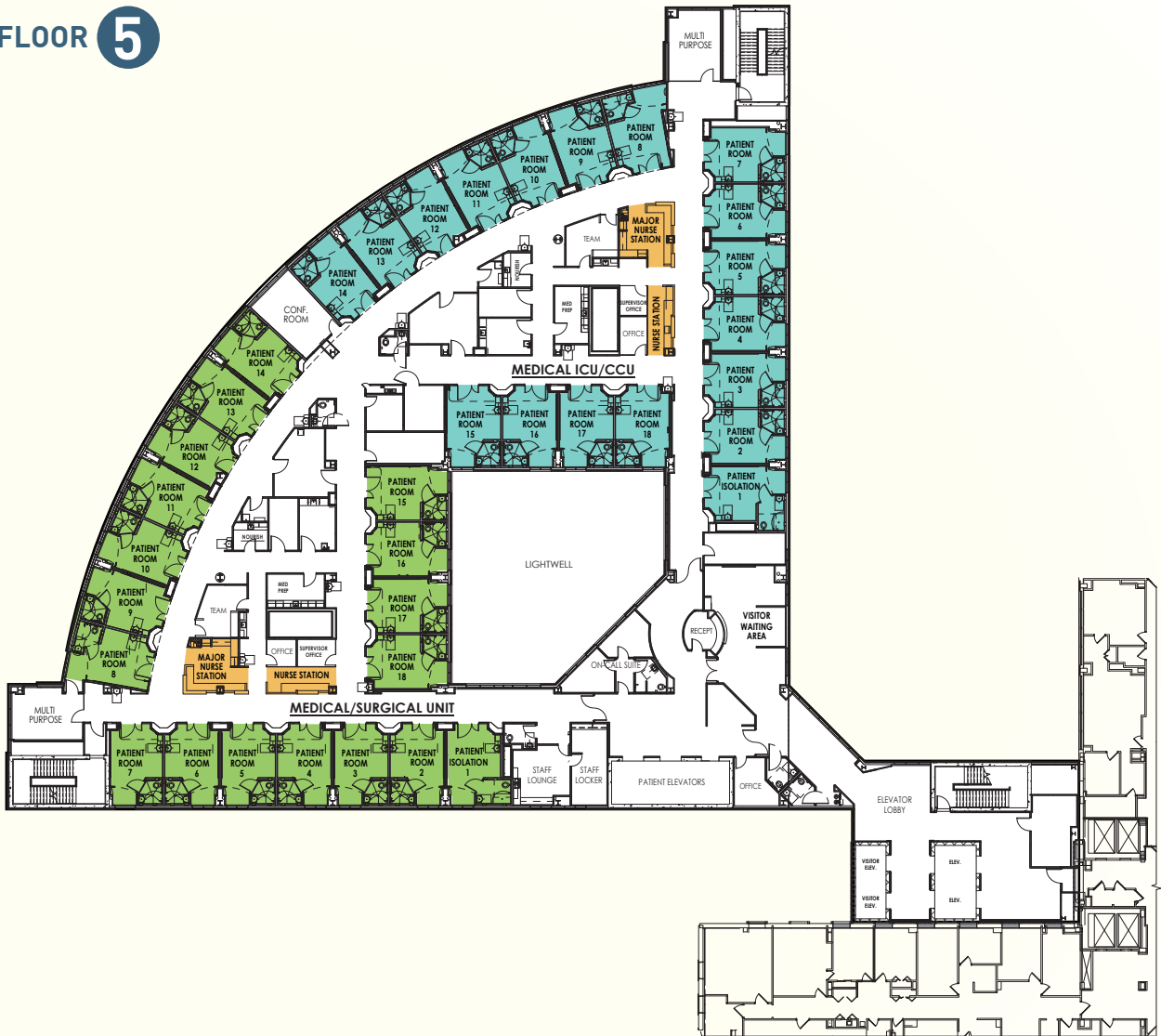

The fifth floor is the first of three identical patient bed floors, each of which feature 36 private, acuity-adaptable rooms. Providing different levels of care in the same room results in greater efficiency and better outcomes.

- The floor includes a Medical ICU and Medical/Surgical Unit, each with 18 private patient rooms.
- The patient rooms are large enough to provide patient, family and caregiver “zones,” enhancing the quality of care and comfort.
- Nurse support is extensive, with central stations as well as work stations or “caregiver alcoves” overlooking each room.

See reverse side for named gift opportunities. >>

Gift Opportunities

Large Spaces

	Minimum Gift Level
Patient Floor	\$2,000,000
Medical ICU/Critical Care Unit.....	\$1,000,000
Medical/Surgical Unit.....	\$1,000,000

Additional Rooms

Waiting Area	\$200,000	RESERVED
Private Patient Room (36).....	\$100,000 (ea)	
Conference Room.....	\$50,000	
Multi-Purpose Room (2).....	\$50,000 (ea)	
On-Call Suite.....	\$50,000	
Major Nurse Station – MICU.....	\$35,000	
Major Nurse Station – Med/Surg.....	\$35,000	
Reception.....	\$35,000	
Nurse Station – MICU	\$25,000	
Nurse Station – Med/Surg.....	\$25,000	
Staff Lounge.....	\$25,000	
Nurse Supervisor Office – MICU	\$25,000	
Nurse Supervisor Office – Med/Surg.....	\$25,000	
Team Room – MICU	\$20,000	
Team Room – Med/Surg.....	\$20,000	
Caregiver Alcove (16)	\$10,000 (ea)	

Your Support Matters

By supporting this key project within Rochester Regional Health's Because *Care Matters* Campaign, you are helping us create a highly advanced care environment that will accommodate increasingly complex medical procedures, better control infection and provide enhanced multidisciplinary, patient- and family-centered care.

To take a virtual tour of the new building online, visit:
give.rochesterregional.org/S4Ctour

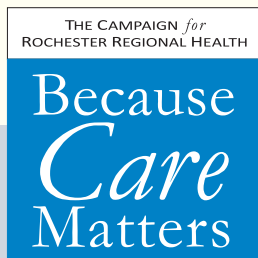

BecauseCareMatters.org

For more information on available naming opportunities, please contact the Rochester Regional Health Foundations Office at Foundations@RochesterRegional.org or 585.922.4800.

ROCHESTER
REGIONAL HEALTH