

Sands-Constellation Center for Critical Care

Surgical ICU and Medical/Surgical Unit

FLOOR 8

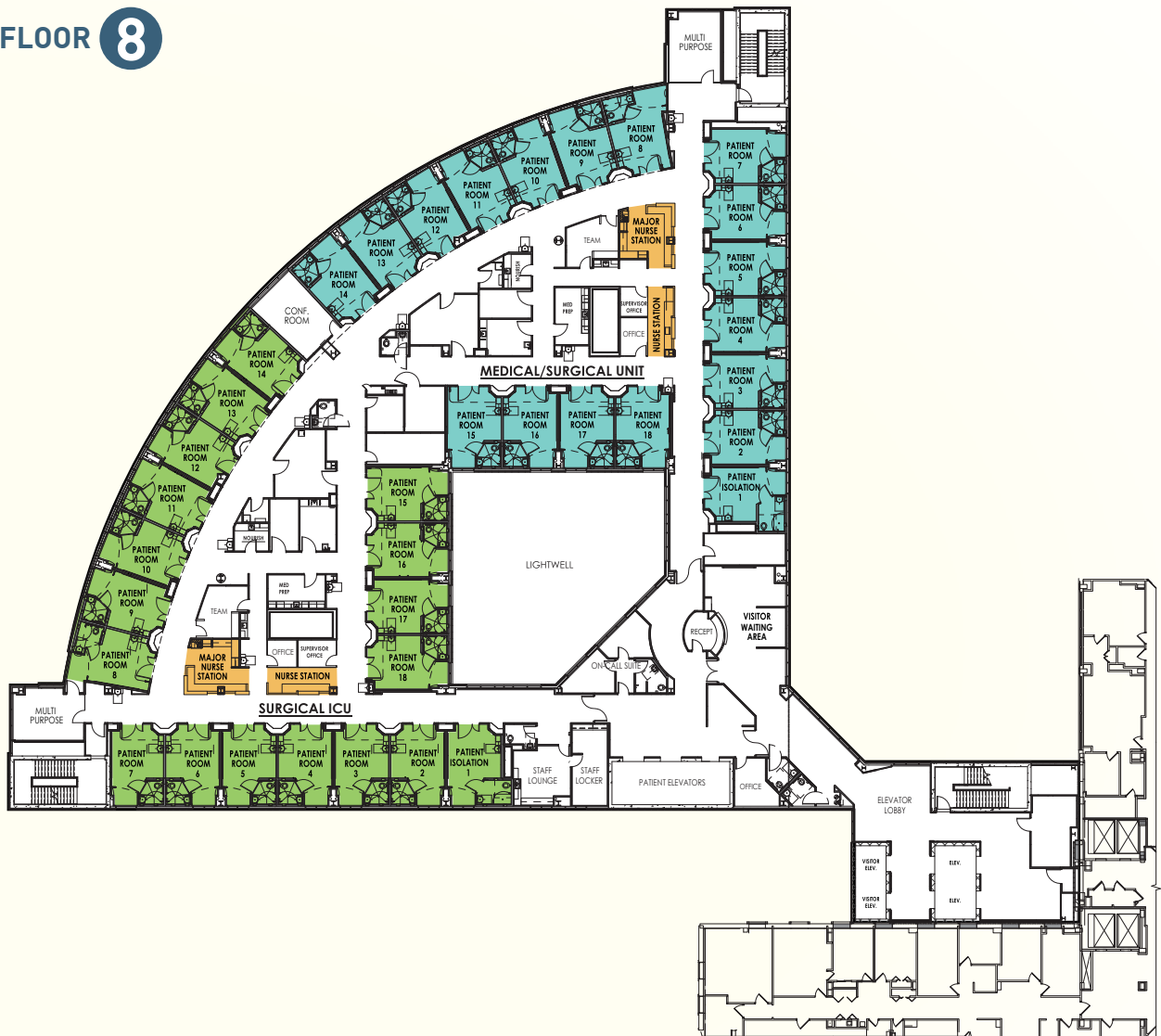

The eighth floor features 36 private, acuity-adaptable patient rooms for the Surgical ICU and an additional Medical/Surgical Unit, which means our care teams are better able to adapt to the level of care each patient needs.

- Private rooms are large enough to provide patient, family and caregiver “zones,” enhancing the quality of care and comfort.
- Extensive nurse support is provided through centrally located stations as well as individual work stations or “caregiver alcoves” overlooking each room.

See reverse side for named gift opportunities. >>

Gift Opportunities

**Minimum
Gift Level**

Large Spaces

Patient Floor	\$2,000,000
Surgical ICU	\$1,000,000
Medical/Surgical Unit	\$1,000,000

Additional Rooms

Waiting Area	\$200,000
Private Patient Room (35)	\$100,000 (ea)
Conference Room.....	\$50,000
Multi-Purpose Room (2).....	\$50,000 (ea)
On-Call Suite.....	\$50,000
Major Nurse Station – SICU	\$35,000
Major Nurse Station – Med/Surg	\$35,000
Reception.....	\$35,000
Nurse Station – SICU	\$25,000
Nurse Station – Med/Surg.....	\$25,000
Staff Lounge.....	\$25,000
Nurse Supervisor Office – SICU.....	\$25,000
Nurse Supervisor Office – Med/Surg.....	\$25,000
Team Room – SICU.....	\$20,000
Team Room – Med/Surg.....	\$20,000
Caregiver Alcove (16)	\$10,000 (ea)

Your Support Matters

By supporting this key project within Rochester Regional Health's Because *Care Matters* Campaign, you are helping us create a highly advanced care environment that will accommodate increasingly complex medical procedures, better control infection and provide enhanced multidisciplinary, patient- and family-centered care.

To take a virtual tour of the new building online, visit:
give.rochesterregional.org/S4Ctour

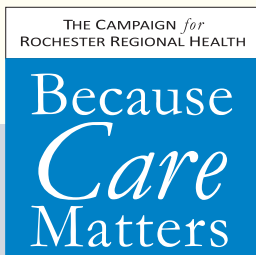

BecauseCareMatters.org

For more information on available naming opportunities, please contact the Rochester Regional Health Foundations Office at Foundations@RochesterRegional.org or 585.922.4800.

ROCHESTER
REGIONAL HEALTH