

Sands-Constellation Center for Critical Care Oncology and Medical/Surgical Unit

FLOOR 6

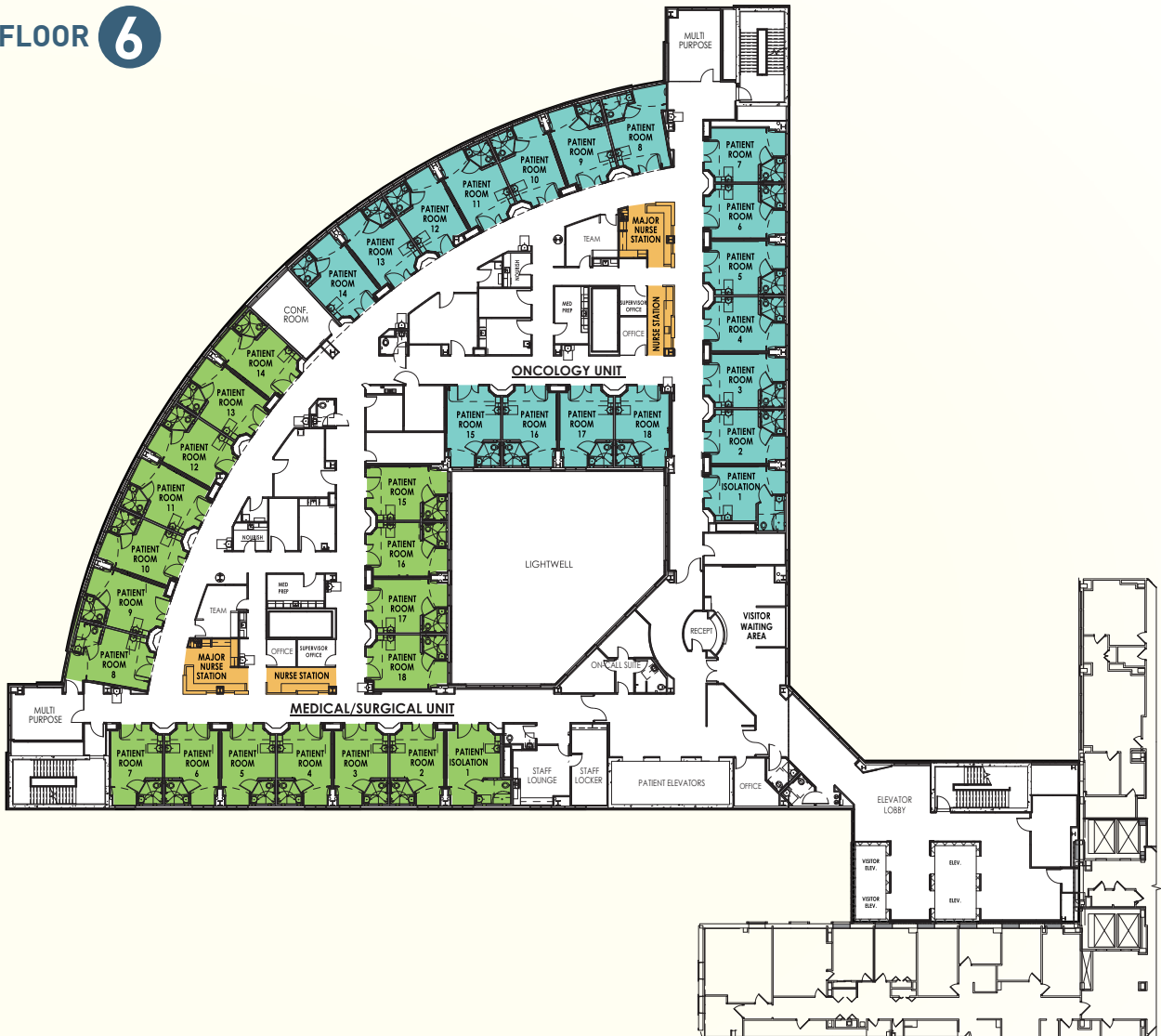

The sixth floor provides for the expansion of the Lipson Cancer Institute's footprint at RGH through a dedicated unit for cancer patients. In particular, it allows for growth in our hematologic cancer care as well as the development of future treatment programs.

- A total of 36 private patient rooms offer much-needed acute care facilities in a modernized, protective environment.
- The patient rooms are large enough to provide patient, family and caregiver "zones," enhancing the quality of care and comfort.
- Nurse support is extensive, with central stations as well as work stations or "caregiver alcoves" overlooking each room.

See reverse side for named gift opportunities. >>

Gift Opportunities

Large Spaces

	Minimum Gift Level
Patient Floor	\$2,000,000
Oncology Unit	\$1,000,000
Medical/Surgical Unit	\$1,000,000

Additional Rooms

Waiting Area	\$200,000	RESERVED
Private Patient Room (35)	\$100,000 (ea)	
Conference Room.....	\$50,000	
Multi-Purpose Room – Oncology	\$50,000	
Multi-Purpose Room – Med/Surg.....	\$50,000	RESERVED
On-Call Suite.....	\$50,000	
Major Nurse Station – Oncology	\$35,000	
Major Nurse Station – Med/Surg	\$35,000	
Reception.....	\$35,000	
Nurse Station – Oncology	\$25,000	
Nurse Station – Med/Surg.....	\$25,000	
Staff Lounge.....	\$25,000	
Nurse Supervisor Office – Oncology	\$25,000	
Nurse Supervisor Office – Med/Surg.....	\$25,000	
Team Room – Oncology	\$20,000	
Team Room – Med/Surg.....	\$20,000	
Caregiver Alcove (16)	\$10,000 (ea)	

Your Support Matters

By supporting this key project within Rochester Regional Health's Because *Care Matters* Campaign, you are helping us create a highly advanced care environment that will accommodate increasingly complex medical procedures, better control infection and provide enhanced multidisciplinary, patient- and family-centered care.

To take a virtual tour of the new building online, visit:
give.rochesterregional.org/S4Ctour

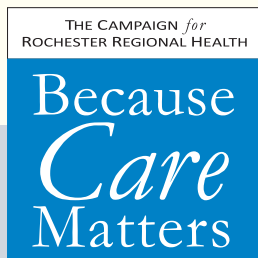

BecauseCareMatters.org

For more information on available naming opportunities, please contact the Rochester Regional Health Foundations Office at Foundations@RochesterRegional.org or 585.922.4800.

ROCHESTER
REGIONAL HEALTH